

Formulate Master 3D Hanging Structures: Tiered Ring Flat

TIER-RNG-FLT-10, TIER-RNG-FLT-12, TIER-RNG-FLT-14, TIER-RNG-FLT-16

Formulate® tension fabric hanging structures are made in the USA and are of the utmost quality and durability. Formulate combines state-of-the-art zipper pillowcase dye-sublimated stretch fabric coverings with advanced, lightweight aluminum structures to provide unique design, functionality, and style.



features and benefits:

- Premium aluminum frames constructed with 30mm (1.18") and 50mm (2") tubes
- Internal expanding spigot and snap button connectors for unmatched structural integrity
- Easy to assemble, store and ship
- Quick to set up
- Three zipper double sided printed pillowcase fabric graphics
- Lifetime limited hardware warranty against manufacturer defects

dimensions:

Hardware

Assembled unit:

(10', 12', 14', or 16') diameter x 1.3' h
(3.1, 3.6, 4.2, or 4.8m) diameter x .4m h

Approximate weight with cases:

Depending on size, weight varies between:
112.46lbs/51.01kgs - 299.09lbs/135.66kgs

Shipping

Packing case(s):

1-4 expandable cardboard boxes depending on size

Shipping dimensions:

Expandable cardboard box length (l) may vary
45-98"l x 16"w x 16"h
1143 - 2489.2mm(l) x 406.4mm(w) x 406.4mm(h)

Approximate total shipping weight
(includes cases & graphics):

Depending on size, weight varies between:
147.82 lbs / 67 kgs - 355.67 lbs / 161 kgs

Graphic

Graphic dimensions can be found in the graphic templates.

For more information visit:
www.Exhibitors-handbook.com/graphic-templates

additional information:

Graphic material:
dye-sublimation zipper pillowcase fabric

We are continually improving and modifying our product range and reserve the right to vary the specifications without prior notice. All dimensions and weights quoted are approximate and we accept no responsibility for variance. E&OE. See Graphic Templates for graphic bleed specifications.

Included In Your Kit

Tools, Components, & Connectors



ALLEN KEY SET x1



ES30 x24



ES50 x12



EYEBOLT x30



CH-SP6-HD-01 x1



CH-ID-HD-01 x12

Graphics

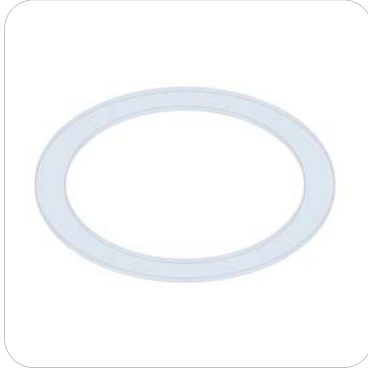

TIER-RNG-FLT-10-TOP-GDBL x1

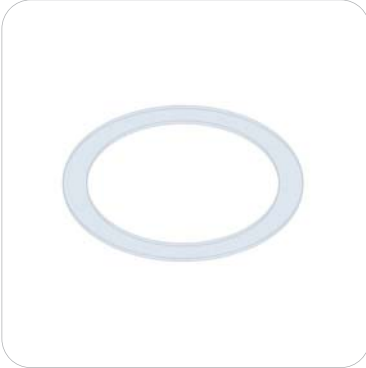

TIER-RNG-FLT-10-MDL-GDBL x1

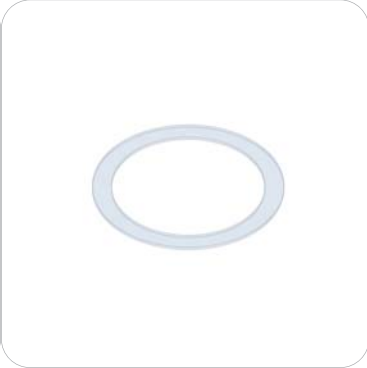

TIER-RNG-FLT-10-BTM-GDBL x1

Included In Your Kit



TIER-RNG-FLT-10-T1 x6



TIER-RNG-FLT-10-T2 x6



TIER-RNG-FLT-10-T3 x6



TIER-RNG-FLT-10-T4 x6



TIER-RNG-FLT-10-T5 x6

Tubes



TIER-RNG-FLT-10-T6 x6



TIER-RNG-FLT-T7 x12



TIER-RNG-FLT-T8 x6

Exploded View

TIER-RNG-FLT-10

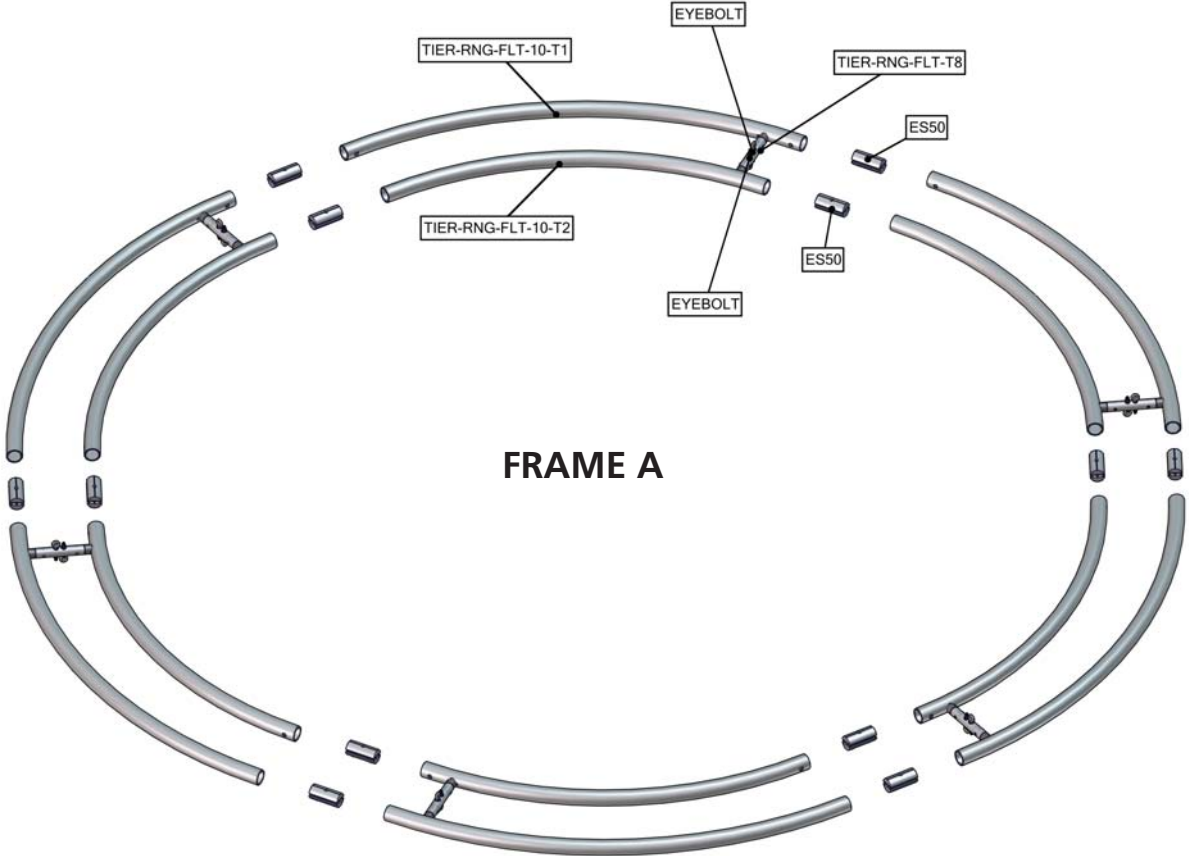

Exploded View

TIER-RNG-FLT-10

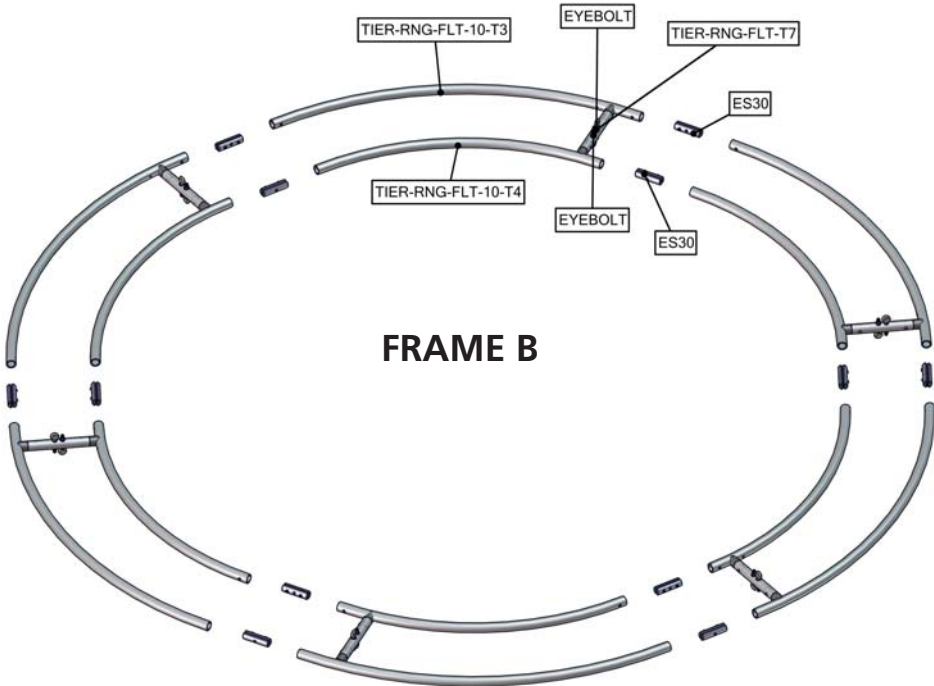

Exploded View

TIER-RNG-FLT-10

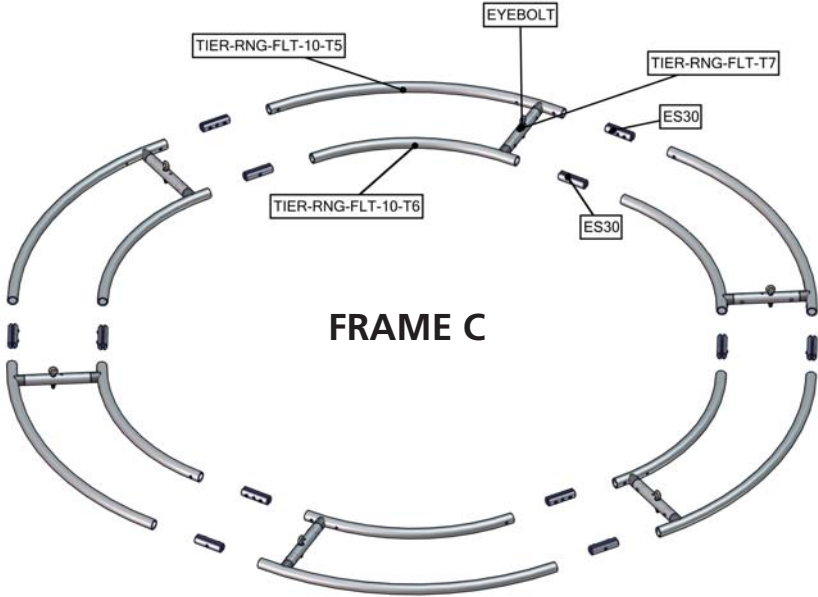

Labeling Diagram

TIER-RNG-FLT-10

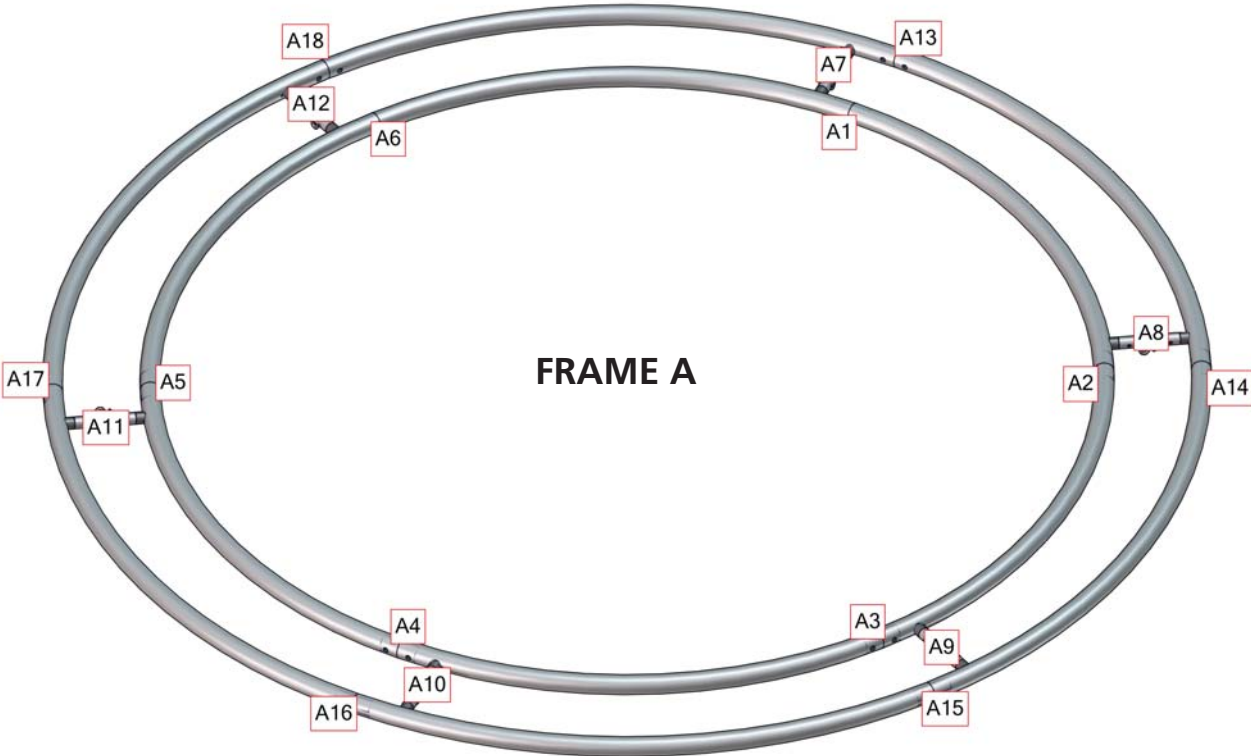

Labeling Diagram

TIER-RNG-FLT-10

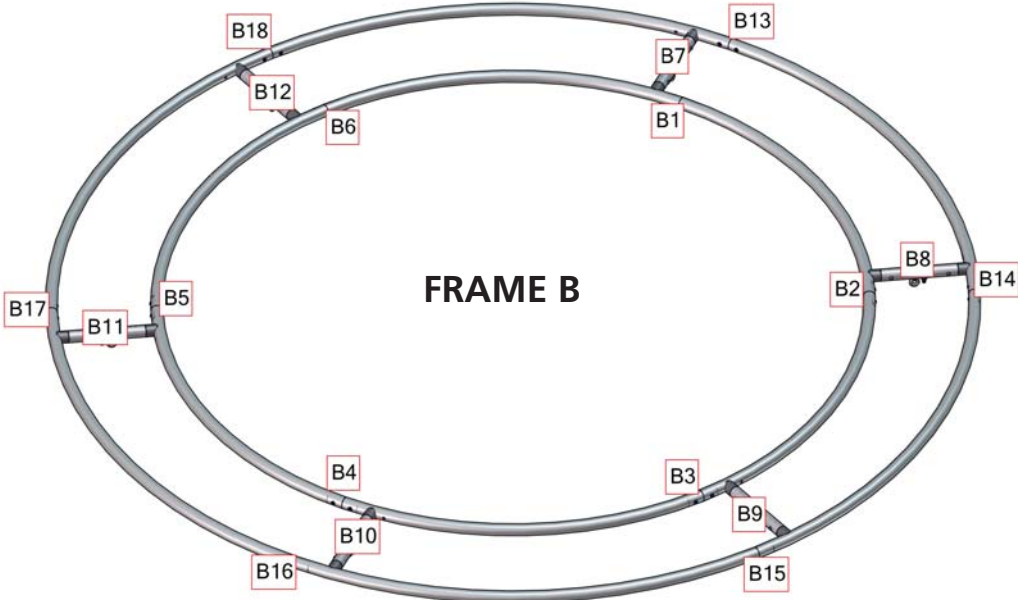

Labeling Diagram

TIER-RNG-FLT-10

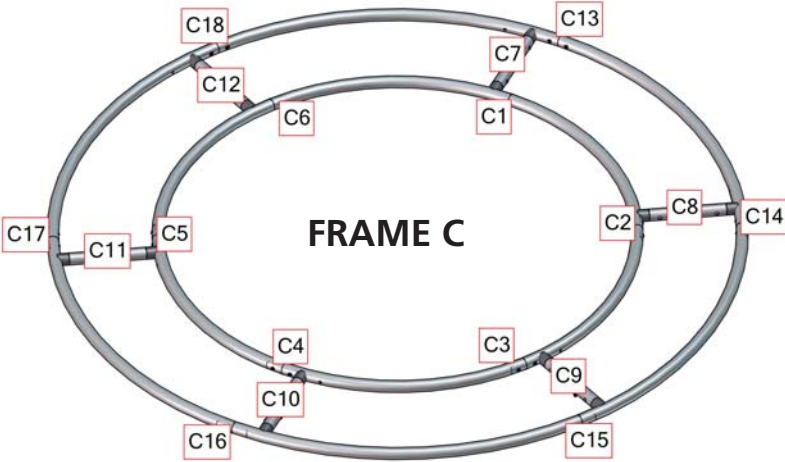

Connection Methods

Formulate® structures use a number of different yet simple connection methods. Your kit will include one or more of the connection methods shown below. Steps within the Kit Assembly will reference a specific method for each connection point.

Connection Method 1: ES30 / ES50 / ES75

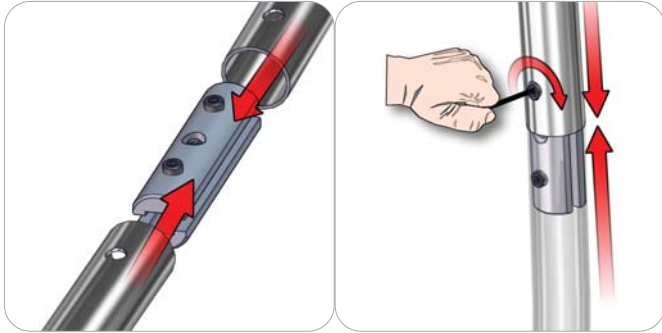

Compress the unlocked connector and slide one tube onto each end. Lock both screws carefully using your allen key tool. Be sure to lock securely, but do not overtighten.

Connection Method 2: Snap Buttons & Swage

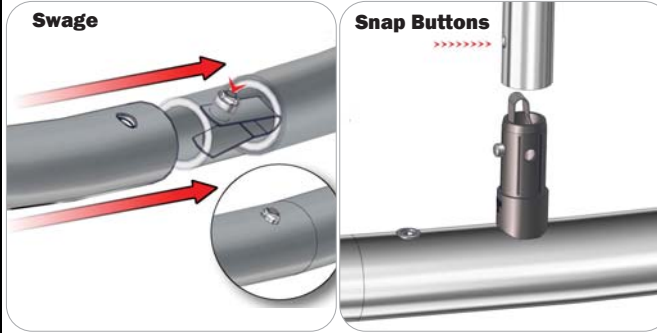

Locate the snap button on the connector or swage tube. Locate the hole on the corresponding tube. Press the snap button with your thumb and slide the tube and connector together so that the snap button snaps fully into the lock hole. To disassemble, press the snap button and pull apart.

Connection Method 3: ES30-90B / ES30-I / ES30-C

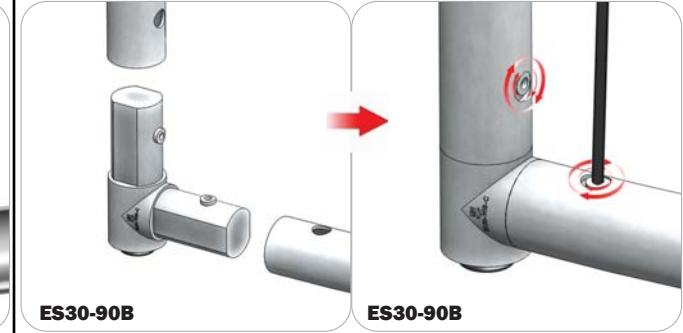

Compress one unlocked end of the connector and slide it through one tube end. Compress the other end of the connector and slide the second tube on. Lock both screws carefully using your allen key tool. Be sure to lock securely, but do not overtighten.

Connection Method 4: Tube Clamps

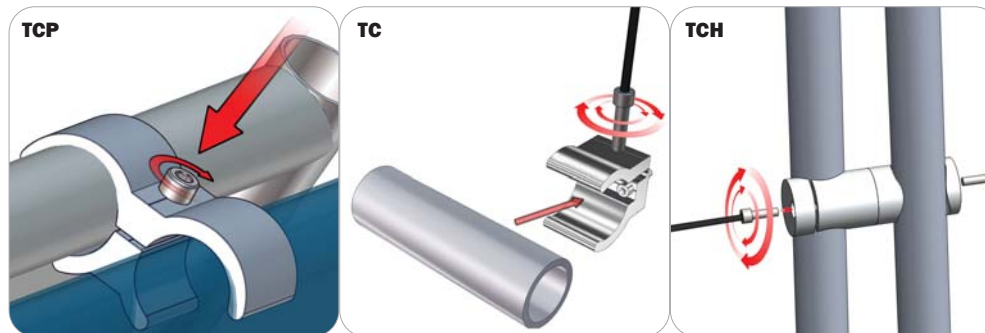

Be sure to fully assemble all frames before using clamps. With the clamp unlocked, place one tube of the first frame into the mouth of the clamp. Place the second tube (if applicable) into the second mouth of the clamp. With both frame's tubes in the clamp, be sure to lock securely, but do not overtighten.

Kit Assembly

Step by Step

Step 1.

Gather the components necessary for assembling Frame A. Assemble in order according to the Labeling Diagram.

Please reference Connection Method 1 and 2 for more details.

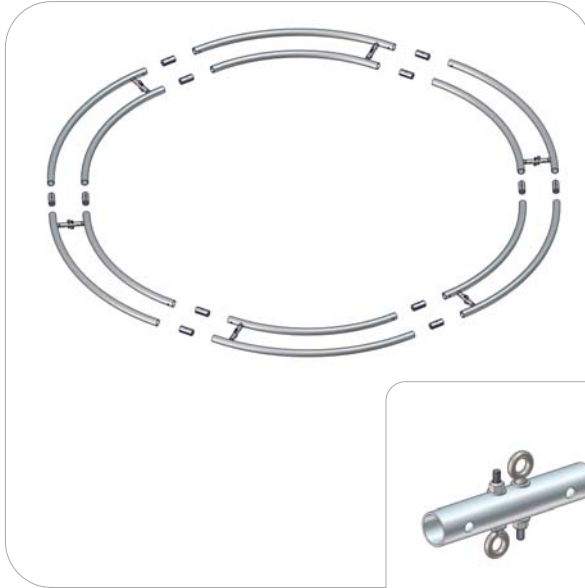

Step 2.

Apply the pillowcase graphic onto the frame. The eyebolts should protrude from above and below at six points. Zipper the pillowcase closed from the inside perimeter.

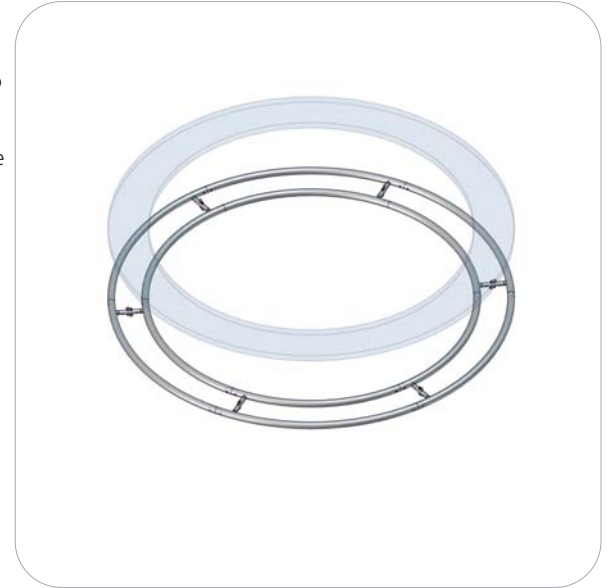

Step 3.

Gather the components necessary for assembling Frame B. Assemble in order according to the Labeling Diagram.

Please reference Connection Method 1 and 2 for more details.

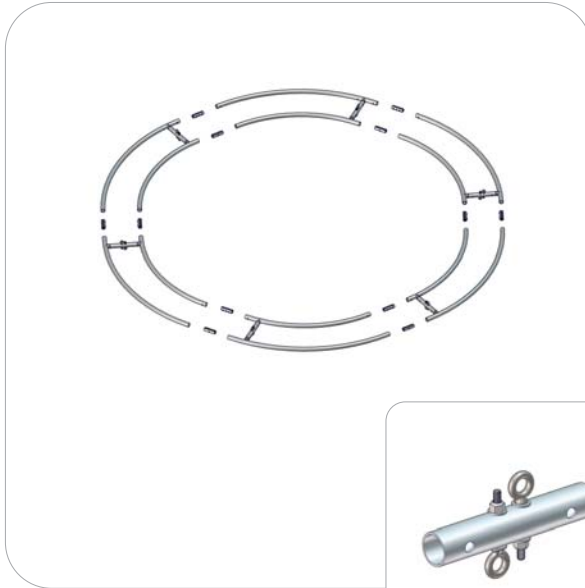

Step 4.

Apply the pillowcase graphic onto the frame. The eyebolts should protrude from above and below at six points. Zipper the pillowcase closed from the inside perimeter.

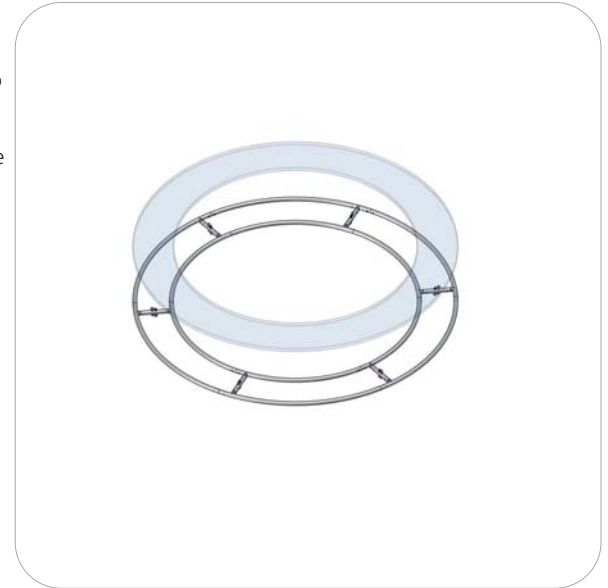

Kit Assembly

Step by Step

Step 5.

Gather the components necessary for assembling Frame C. Assemble in order according to the Labeling Diagram.

Please reference Connection Method 1 and 2 for more details.

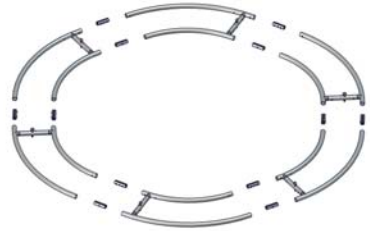
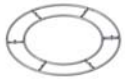

Step 6.

Apply the pillowcase graphic onto the frame. The eyebolts should protrude from above at six points. Zipper the pillowcase closed from the inside perimeter.



Step 7.

Gather the components necessary for linking the frames.



A



B



C



Step 8.

Setup Complete

